

## CFMOTO 450NK '24

REF 21905N

PORTAMATRÍCULA / LICENSE SUPPORT



1 Person









1 hour

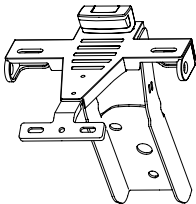
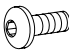

INTERMEDIATE

Accesorio verificado en la configuración básica de la motocicleta. Para modelos con configuraciones adicionales de fábrica, no podemos asegurar su compatibilidad a menos que se realice una consulta previa. Declinamos cualquier reclamación eventual.

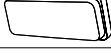
Accessory verified in the basic configuration of the motorcycle. For models with additional factory settings, we cannot guarantee its compatibility, except with prior consultation. We decline any potential claims.

ID.	PIEZA / PART	DESCRIPCIÓN	ESCRPTION	QTY.	REF.:
1		Soporte portamatrículas	License support	1	CONJUNTO-21905N
2		Tornillo M8x15 ISO7380 (Negro)	M8x15 ISO7380 screw (Black)	3	TORNI-I7380-497
3		Silentblock goma	Rubber silentblock	1	SILENBGONE--064
4		Brida de plástico	Plastic bridle	5	BRIDAN100X2'5N
5		Luz portamatrículas	Back light	1	5577N
6		Catadrióptico	Reflector	1	4481R
7		Tapón cabota tornillo M6 DIN1001	M6 DIN1001 screw cap	4	TAPON-----85
8		Tapón cabota tornillo M5 DIN1001	M5 DIN1001 screw cap	1	TAPON-----86

# CFMOTO 450NK '24

REF  
21905N

INSTRUCCIONES DE MONTAJE - MOUNTING INSTRUCTIONS - MONTAGEANLEITUNG

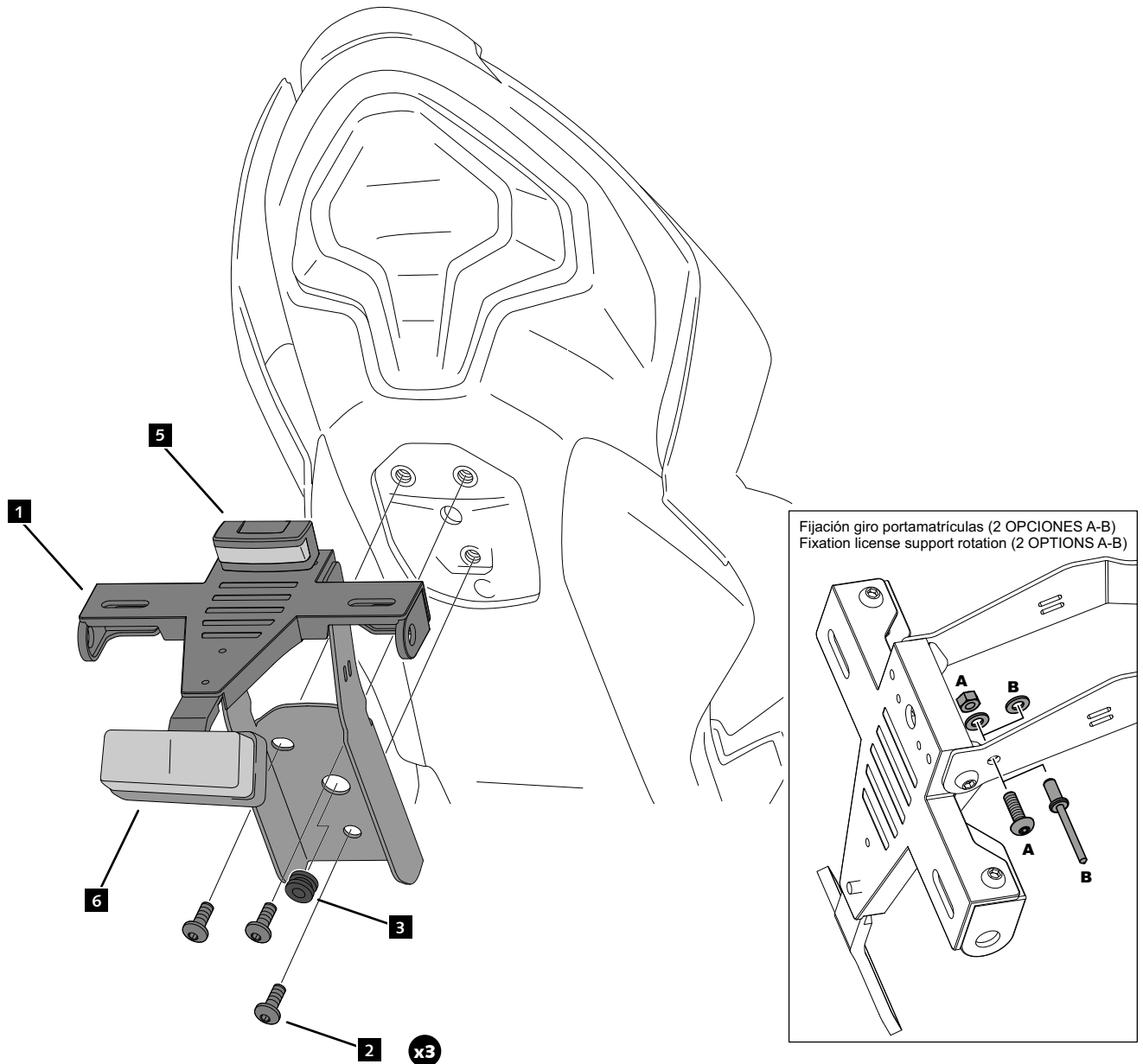

**CONSULTAR EN NUESTRA PAGINA WEB LA DISPONIBILIDAD DEL VIDEO DE MONTAJE DE ESTA REFERENCIA.  
CONSULT OUR WEBSITE THE VIDEO MOUNT AVAILABILITY OF THIS REFERENCE.**

