

QJ SRT 550X TRAIL / SRT 550 ON ROAD / SRT 700X TRAIL '23-

M O U N T I N G I N S T R U C T I O N S

REF 21772

EXTENDED FRONT DEFLECTORS

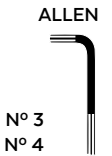

ID.	PIEZA/PART	DESCRIPCIÓN	DESCRIPTION	QTY.	REF.:
1		Deflector derecho	Right deflector	1	21772W/H/F/NM3
2		Deflector izquierdo	Left deflector	1	21772W/H/F/NM3
3		Tornillo especial M6x17 Long Hexagonal 20 (Rosca int M5x15)	M6x17 special screw Hexagonal lenght 20	2	TORNI-EM6---800
4		Arandela de nylon M6	M6 nylon washer	6	ARANDEPNVCN0246
5		Silentblock Ø9xØ6x8mm	Ø9xØ6x8mm Silentblock	2	AROPASACABLES-3
6		Casquillo con valona Ø12xØ6,8x7,3	Ø12xØ6,8x7,3 bush with flange	2	CASQUI-1A---750
7		Tornillo allen M5x16 Ø11 ISO 7380	M5x16 Ø11 ISO 7380 Allen screw	2	TORNI-I7380-493
8		Tapón tornillo M5 ISO 7380	M5 ISO 7380 screw cap	2	TAPON-----85

QJ SRT 550X TRAIL / SRT 550 ON ROAD / SRT 700X TRAIL '23-

INSTRUCCIONES DE MONTAJE - MOUNTING INSTRUCTIONS - MONTAGEANLEITUNG

Se muestra el montaje del lado izquierdo a modo de ejemplo, realizar los mismos pasos para el montaje del lado derecho.
The left side assembly is shown as an example, so the same steps can be performed for the right side assembly.

1

**DISASSEMBLY
DESMONTAJE**

A Tornillería original
Original screws

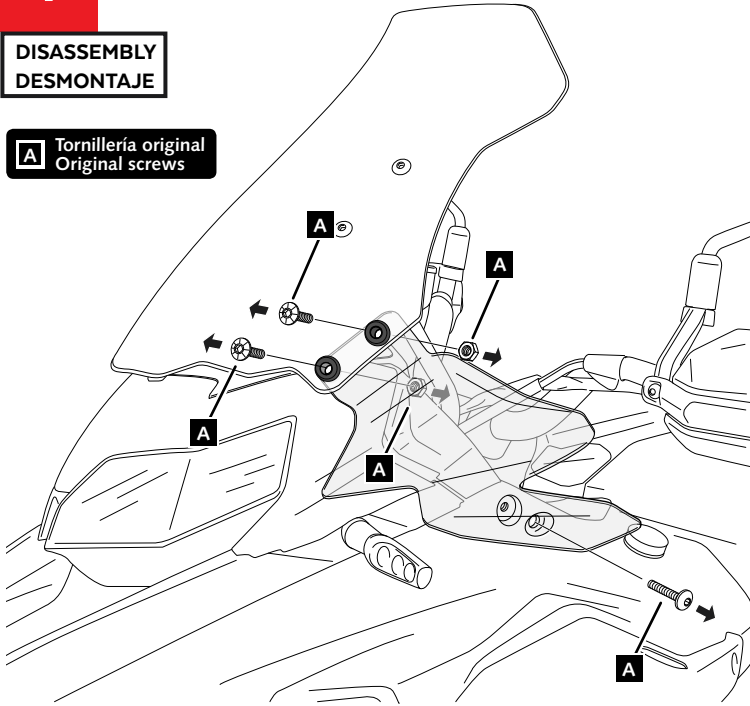

2

**ASSEMBLY
MONTAJE**

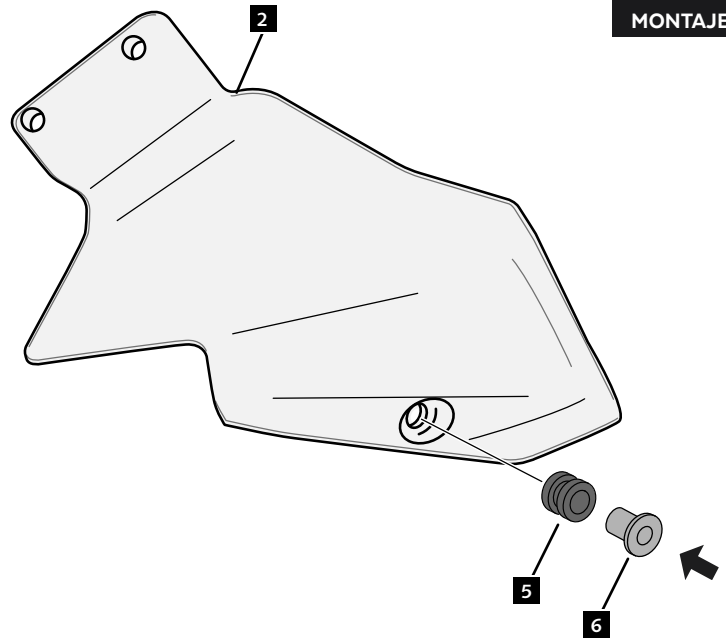

3

**ASSEMBLY
MONTAJE**

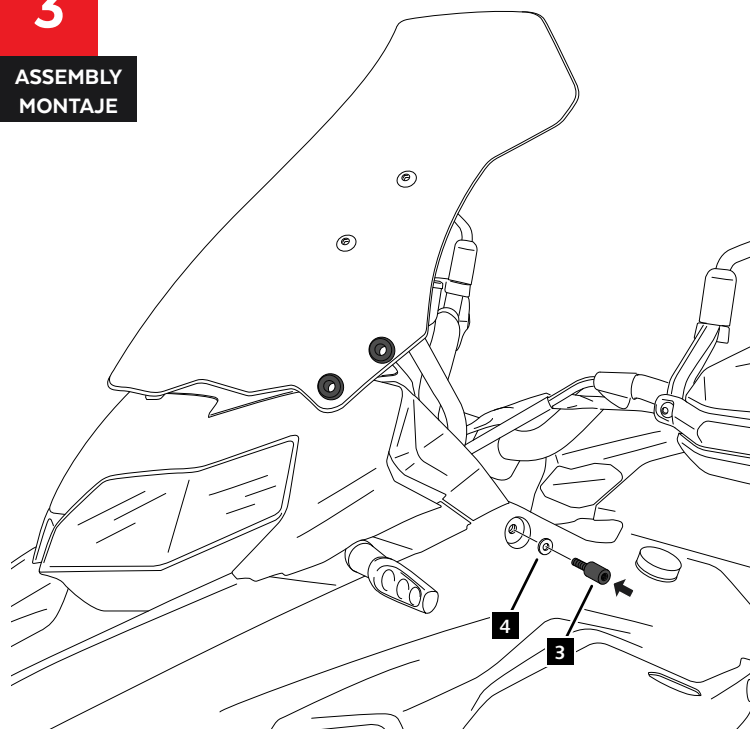

4

**ASSEMBLY
MONTAJE**

