

DUCATI DIAVEL V4 '23-

M O U N T I N G I N S T R U C T I O N S

REF 21713

WINDSHIELD NG ADJUSTABLE



1 Person



15min



EASY



ALLEN

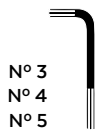

N° 3
N° 4
N° 5

ID.	PIEZA/PART	DESCRIPCIÓN	DESCRIPTION	QTY.	REF.:
1		Cúpula	Screen	1	21713W/H/F/J/NM3
2		Soporte fijo	Fix support	1	SOPOR3P2-F21713
3		Soporte móvil derecho	Mobile Right support	1	SOPOR3P2-R21713
4		Soporte móvil izquierdo	Mobile Left support	1	SOPOR3P2-L21713
5		Pomo accionador	Locking handle	1	POMO-DIAVEL-642
6		Tuerca CIEGA M6	M6 Nut	2	TUERCA-----639
7		Arandela de goma Ø8,5xØ17x1,5	Ø8,5xØ17x1,5 Rubber washer	2	ARAND-----638
8		Arandela de metálica Ø8,5xØ17x1	Ø 8,5xØ17x1 Metal washer	2	ARANDPD125-018
9		Tornillo allen M6x10 Ø14 ISO 7380	M6x10 Ø14 ISO 7380 Allen screw	2	TORNI-I7380-402
10		Casquillo Ø6xØ8x5,5mm	Ø6xØ8x5,5mm Arrowhead	2	CASQUI-----641
11		Arandela de nylon Ø8x1	Ø8x1 Nylon washer	2	ARNV00000000265
12		Adhesivo	Sticker	1	ADHESIV-----213
13		Silentblock Ø9xØ6x8mm	Ø9xØ6x8mm Silentblock	4	AROPASACABLES-3
14		Casquillo con valona Ø12xØ6,8x7,3mm	Ø12xØ6,8x7,3mm Bush with flange	4	CASQUI-1A---750
15		Tornillo allen M5x16 Ø11 ISO 7380	M5x16 Ø11 ISO 7380 Allen screw	4	TORNI-I7380-493
16		Tapón tornillo M5 ISO 7380	M5 ISO 7380 Screw cap	4	TAPON-----85
17		Casquillo Ø8xØ12x32mm	Ø8xØ12x32mm Arrowhead	2	CASQUI-----910
18		Tornillo allen M6x50 DIN912	M6x50 DIN912 Allen screw	2	TORNI-D912--473
19		Casquillo 6,5xØ10x24mm	6,5xØ10x24mm Arrowhead	2	CASQUI-----911
20		Tornillo M6x40 DIN912	M6x40 DIN912 Screw	2	TORNIAD912-0058
21		Tapón M6 DIN 912	M6 DIN 912 screw cap	4	TAPON-----88

DUCATI DIAVEL V4 '23-

INSTRUCCIONES DE MONTAJE - MOUNTING INSTRUCTIONS - MONTAGEANLEITUNG

1

**DISASSEMBLY
DESMONTAJE**

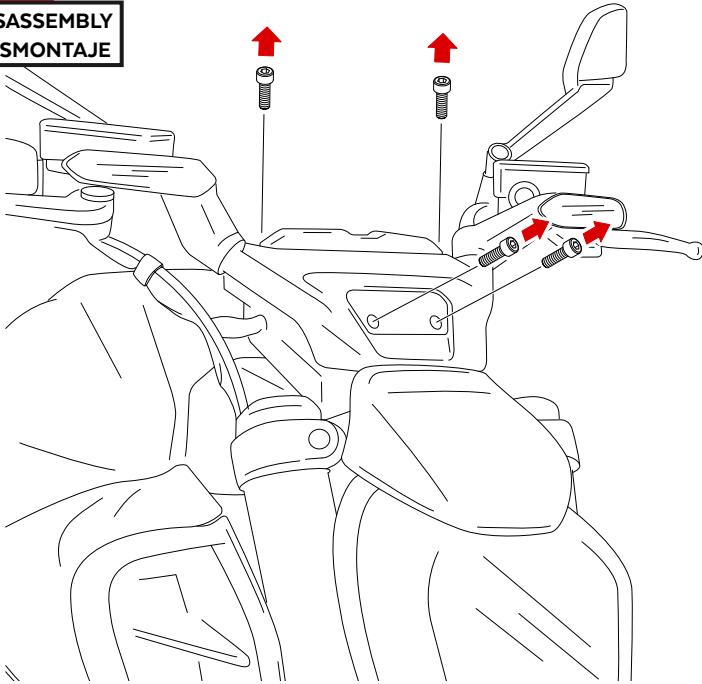

2

**ASSEMBLY
MONTAJE**

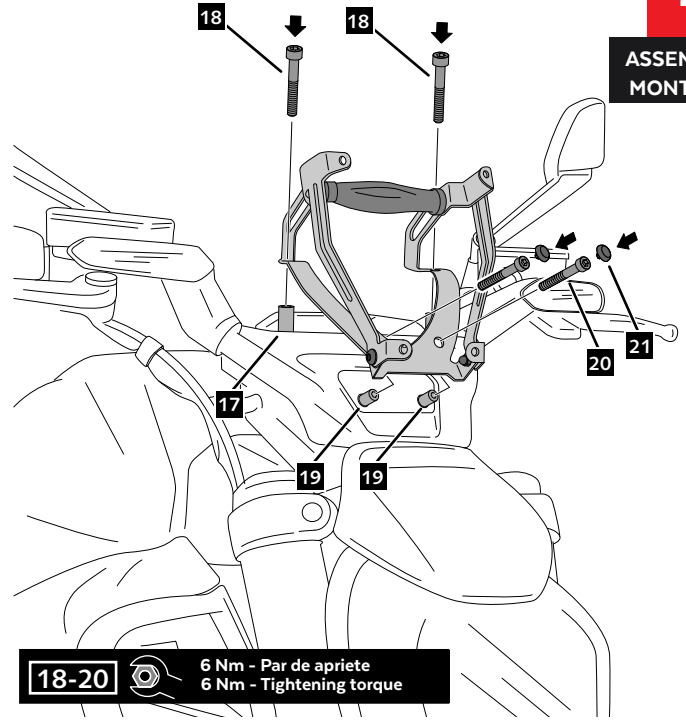

3

**ASSEMBLY
MONTAJE**

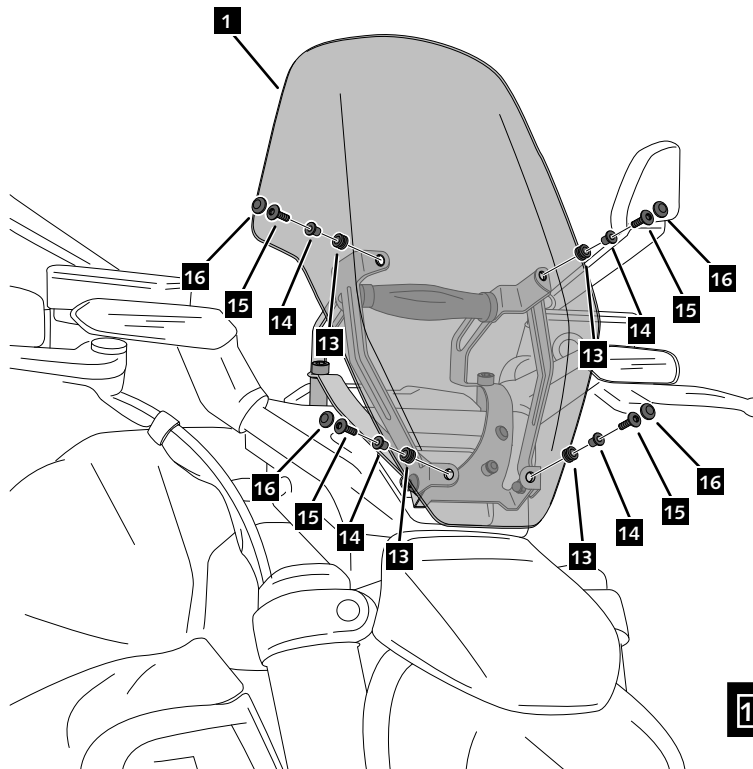

15  3 Nm - Par de apriete
3 Nm - Tightening torque

DUCATI DIAVEL V4 '23-

INSTRUCCIONES DE MONTAJE - MOUNTING INSTRUCTIONS - MONTAGEANLEITUNG

EXPLOTING

