

KTM 990 DUKE '24-

M O U N T I N G I N S T R U C T I O N S

REF 22178

DOWNFORCE NAKED FRONTAL SPOILERS



1 Person



30 min



EASY



TORX
T40



ALLEN
N° 3
N° 5

| ID | PIEZA/PART | DESCRIPCIÓN | DESCRIPTION | QTY | REF |
|----|------------|--|---|-----|-----------------|
| 1 | | Alerón derecho (ABS) | Right spoiler (ABS) | 1 | 11032JM3 |
| 2 | | Alerón izquierdo (ABS) | Left spoiler (ABS) | 1 | 11032JM3 |
| 3 | | Deflector derecho | Right deflector | 1 | 11034TM3 |
| 4 | | Deflector izquierdo | Left deflector | 1 | 11034TM3 |
| 5 | | Soporte derecho | Right support | 1 | SOPOR2P3-R22178 |
| 6 | | Soporte izquierdo | Left support | 1 | SOPOR2P3-L22178 |
| 7 | | Tornillo Allen M8x45 ISO 7380 | M8x45 ISO 7380 Allen screw | 2 | TORNI-I7380-817 |
| 8 | | Casquillo Ø8,5 x Ø13 x 15mm | Ø8,5 x Ø13 x 15mm Arrowhead | 2 | CASQUI-M----614 |
| 9 | | Tornillo Allen M5x16 Ø11 ISO 7380 | M5x16 Ø11 ISO 7380 Allen screw | 2 | TORNI-I7380-493 |
| 10 | | Casquillo Ø8,5 x Ø13 x 3,5mm | Ø8,5 x Ø13 x 3,5mm Arrowhead | 2 | CASQUI-----775 |
| 11 | | Tornillo especial M5x11 Long Hexagonal 15 (rosca int M5x12) | Special screw M5x11 Hexagonal length 15 mm (M5x12) | 4 | TORNI-EM5---781 |
| 12 | | Arandela de goma Ø4,5x Ø11x 2 mm | Ø4,5x Ø11x 2 mm Rubber washer | 8 | ARAND-EPDM--722 |
| 13 | | Arandela de nylon M5 | M5 Nylon washer | 8 | ARNV00000000245 |
| 14 | | Tornillo Allen M5x12 Ø11 ISO 7380 | M5x12 Ø11 ISO 7380 Allen screw | 8 | TORNI-AI----520 |
| 15 | | Tapón tornillo M5 ISO 7380 | M5 ISO 7380 screw cap | 10 | TAPON-----85 |
| 16 | | Cinta auto-adhesiva de doble cara 3M, tamaño pequeño espesor 1,5mm | 3M double-sided self-adhesive tape, small size, thickness 1.5mm | 2 | ADHESI3M--94X23 |
| 17 | | Kit adhesivos | Stickers set | 1 | ADHESI----21909 |

KTM 990 DUKE '24-

INSTRUCCIONES DE MONTAJE - MOUNTING INSTRUCTIONS - MONTAGEANLEITUNG

1

ASSEMBLY
MONTAJE

Se muestra el montaje del lado derecho a modo de ejemplo, realizar los mismos pasos para el montaje del lado izquierdo
The right side assembly is shown as an example, so the same steps can be performed for the left side assembly.

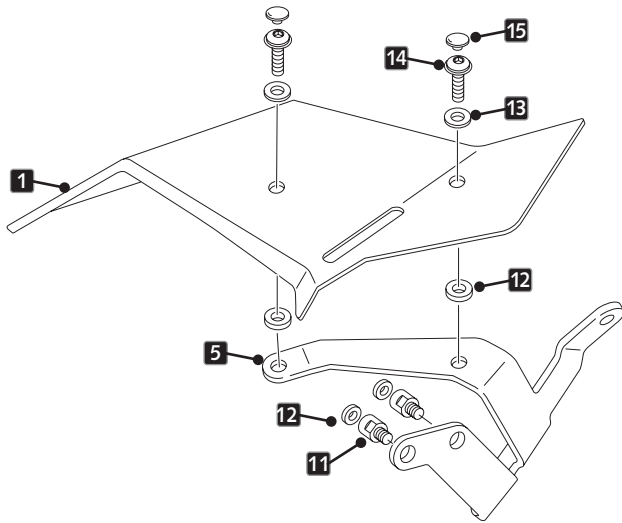

14  Par de apriete - 3 Nm
Tightening torque - 3 Nm

2

ASSEMBLY
MONTAJE

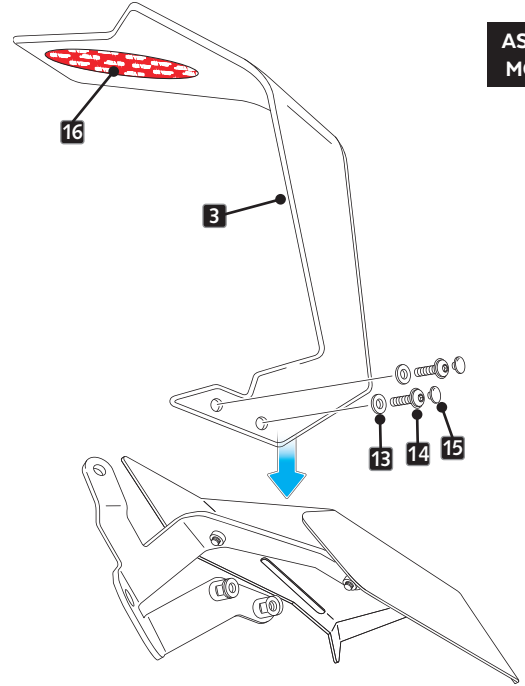

3

ASSEMBLY
MONTAJE



**CLEAN THE SURFACE
WITH NATURAL SOAP.**

**CHECK IS COMPLETELY DRY
BEFORE START.**

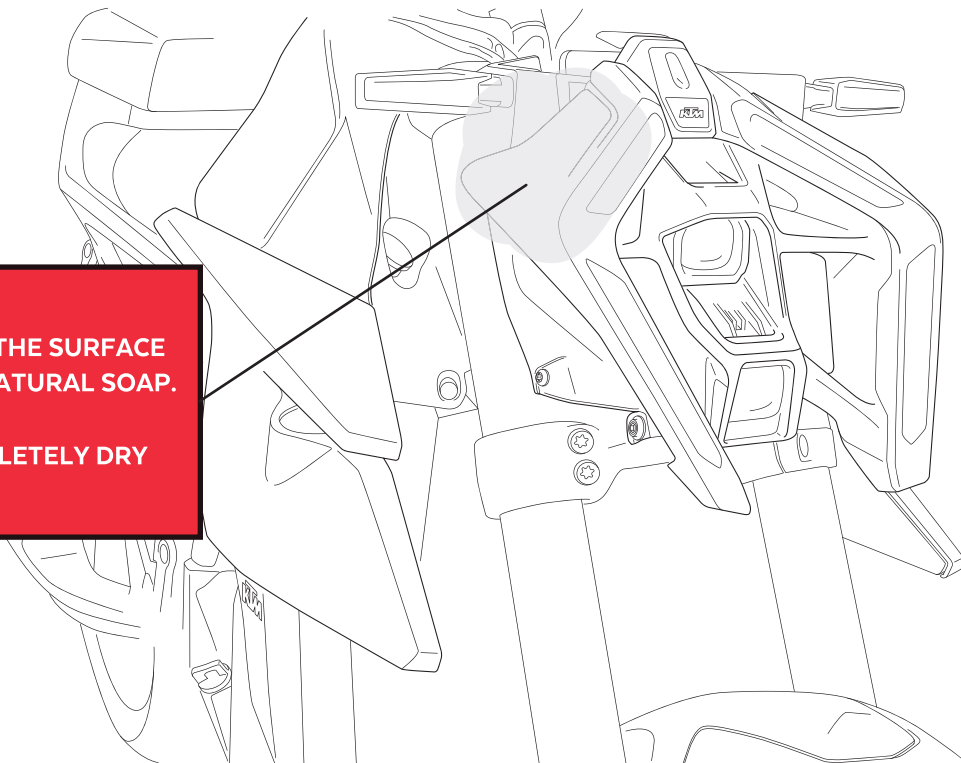

KTM 990 DUKE '24-

INSTRUCCIONES DE MONTAJE - MOUNTING INSTRUCTIONS - MONTAGEANLEITUNG

3

DISASSEMBLY
DESMONTAJE

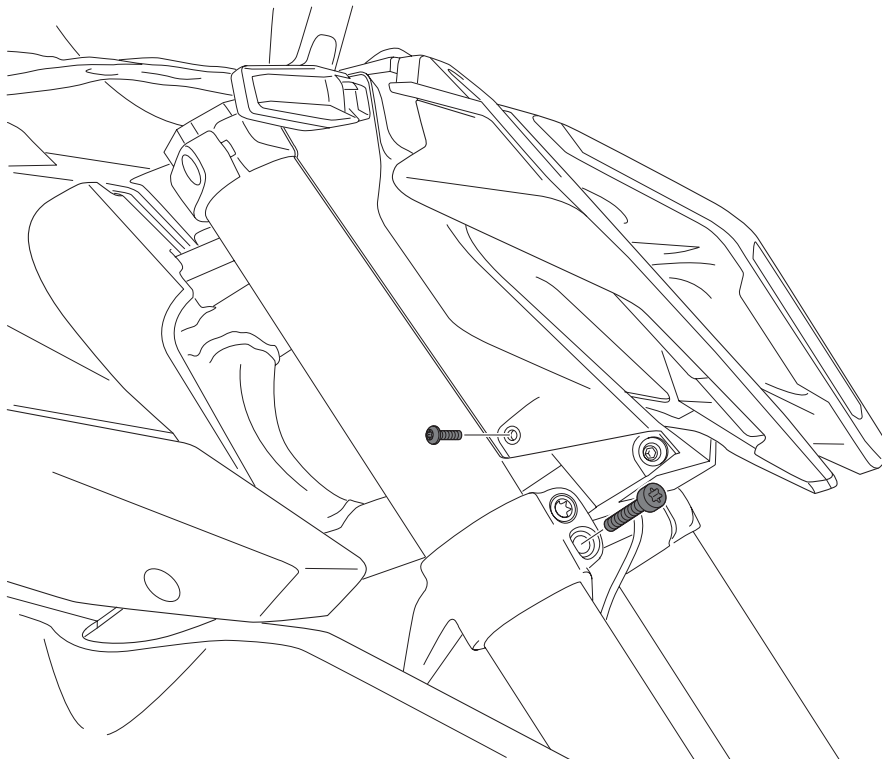

4

ASSEMBLY
MONTAJE

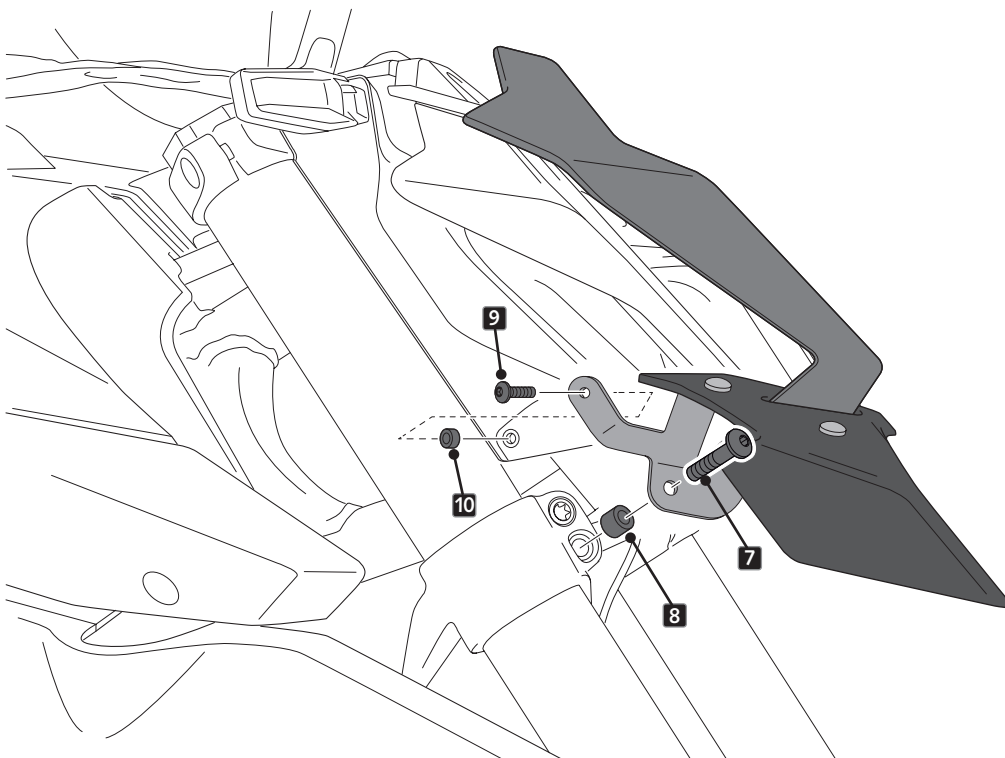

KTM 990 DUKE '24-

INSTRUCCIONES DE MONTAJE - MOUNTING INSTRUCTIONS - MONTAGEANLEITUNG

6

**ASSEMBLY
MONTAJE**

STEP 1

ASEGURAR LA CORRECTA POSICIÓN DEL CONJUNTO, SI ES NECESARIO, AJUSTAR LA POSICIÓN MEDIANTE TORNILLOS ID.9, ID7 Y ID.14.

ENSURE THE CORRECT POSITION OF THE ASSEMBLY, IF NECESSARY, ADJUST THE POSITION USING ID.9, ID7 AND ID.14 SCREWS

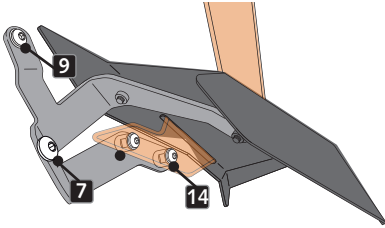

STEP 2

EXTRAER EL PAPEL DEL ADHESIVO 3M
REMOVE PAPER FROM 3M ADHESIVE

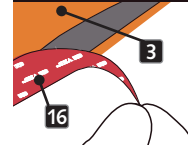

STEP 3

APLICAR PRESION EN EL ÁREA DEL ADHESIVO DURANT 1 MINUTO

APPLY PRESSURE ON ADHESIVE AREA FOR 1 MINUTE

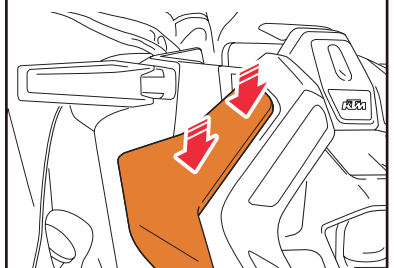

KTM 990 DUKE '24-

INSTRUCCIONES DE MONTAJE - MOUNTING INSTRUCTIONS - MONTAGEANLEITUNG

7

ASSEMBLY
MONTAJE

WAIT 24 HOURS



CHECK THE CORRECT ADHESION
OF THE 3M DOUBLE SIDE
SELF-ADHESIVE TAPE
TO THE FAIRING. ENSURE THAT
THE ENTIRE SURFACE
IS WELL ADHERED

8

ASSEMBLY
MONTAJE

TIGHTEN SCREWS

14  Par de apriete - 3 Nm
Tightening torque - 3 Nm

9  Par de apriete - 4 Nm
Tightening torque - 4 Nm

7  Par de apriete - 12 Nm
Tightening torque - 12 Nm

