

**HONDA CRF1100L AFRICA TWIN '20- / ADVENTURE SPORTS '20-  
/ X-ADV '21- / XL750 TRANSALP '23-**

**M O U N T I N G I N S T R U C T I O N S**

**REF 21771**

**HANDGUARD EXTENSION**



ID	PIEZA/PART	DESCRIPCIÓN	DESCRIPTION	QTY	REF
1		Extensió de paramanos derecho	Right handguard extension	1	21771W/H/FM3
2		Extensión de paramanos izquierdo	Left handguard extension	1	21771W/H/FM3
3		Silentblock Ø18x Ø19x Ø11x 8	Ø18x Ø19x Ø11x 8 silentblock	2	SILENBGONE--064
4		Casquillo con valona M5	M5 Bush with flange	2	CASQUI-----517
5		Tornillo Allen M5x16 Ø11 ISO 7380	M5x16 Ø11 ISO 7380 Allen screw	2	TORNI-I7380-493
6		Tornillo Allen M5x20 Ø11 ISO 7380	M5x20 Ø11 ISO 7380 Allen screw	2	TORNI-I7380-730
7		Arandela nylon M5x1	M5x1 Nylon washer	4	ARNV0000000245
8		Tapón tornillo M5 ISO 7380	M5 ISO 7380 screw cap	4	TAPON-----85

**HONDA CRF1100L AFRICA TWIN '20- / ADVENTURE SPORTS '20-  
/ X-ADV '21- / XL750 TRANSALP '23-**

**INSTRUCCIONES DE MONTAJE - MOUNTING INSTRUCTIONS - MONTAGEANLEITUNG**

**1**

**DISASSEMBLY  
DESMONTAJE**

Se muestra el montaje del lado derecho a modo de ejemplo, realizar los mismos pasos para el montaje del lado izquierdo.  
The right side assembly is shown as an example, so the same steps can be performed for the left side assembly.

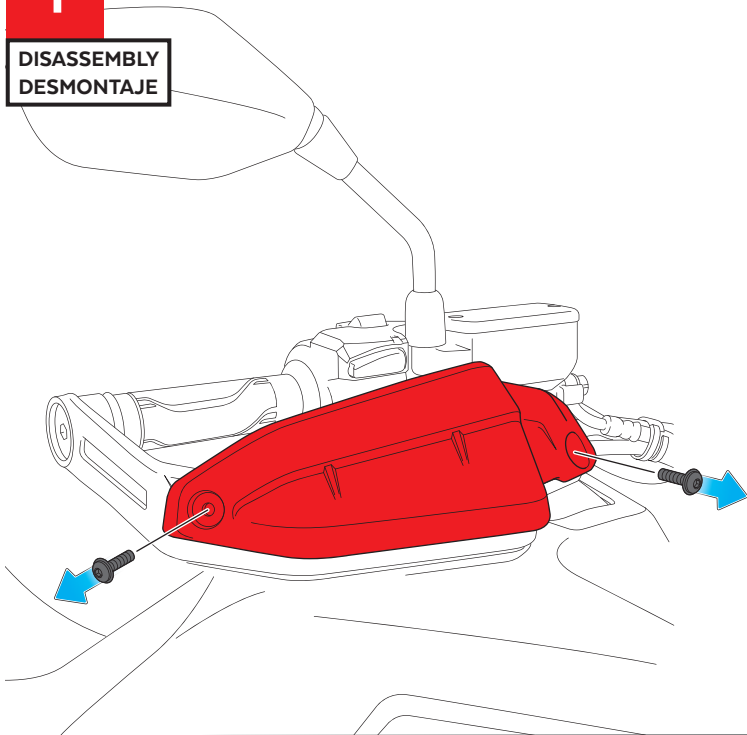

**2**

**DISASSEMBLY  
DESMONTAJE**

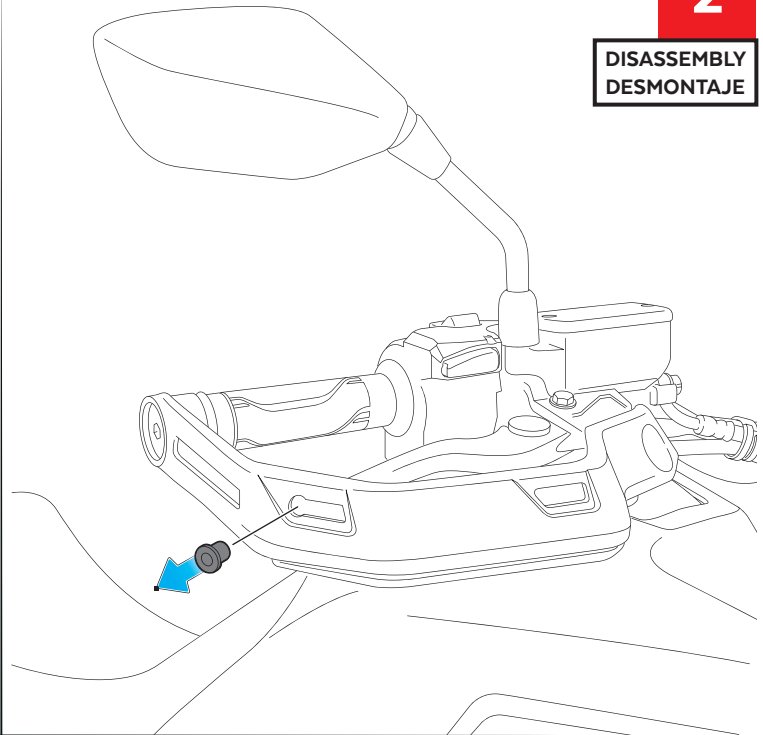

**3**

**ASSEMBLY  
MONTAJE**

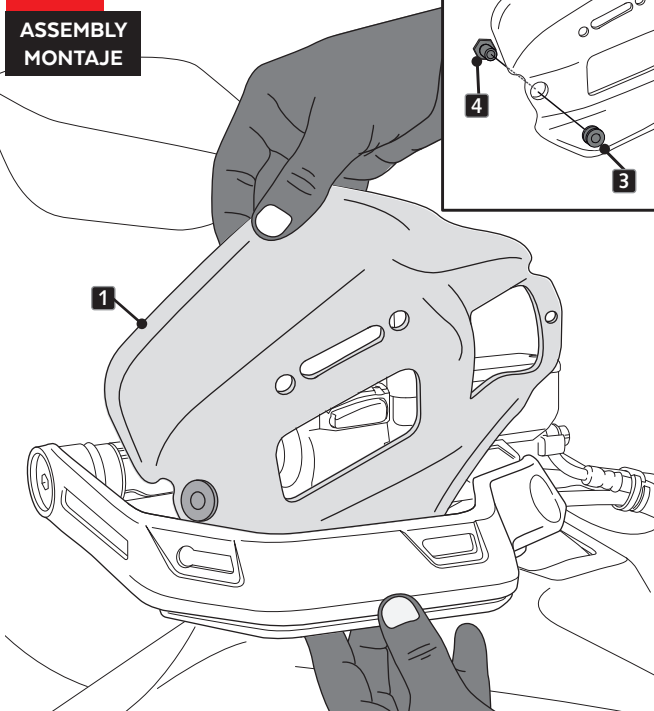
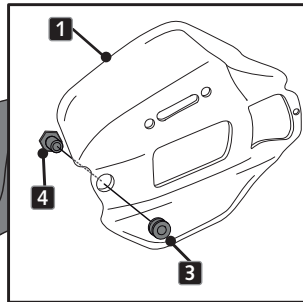

**4**

**ASSEMBLY  
MONTAJE**

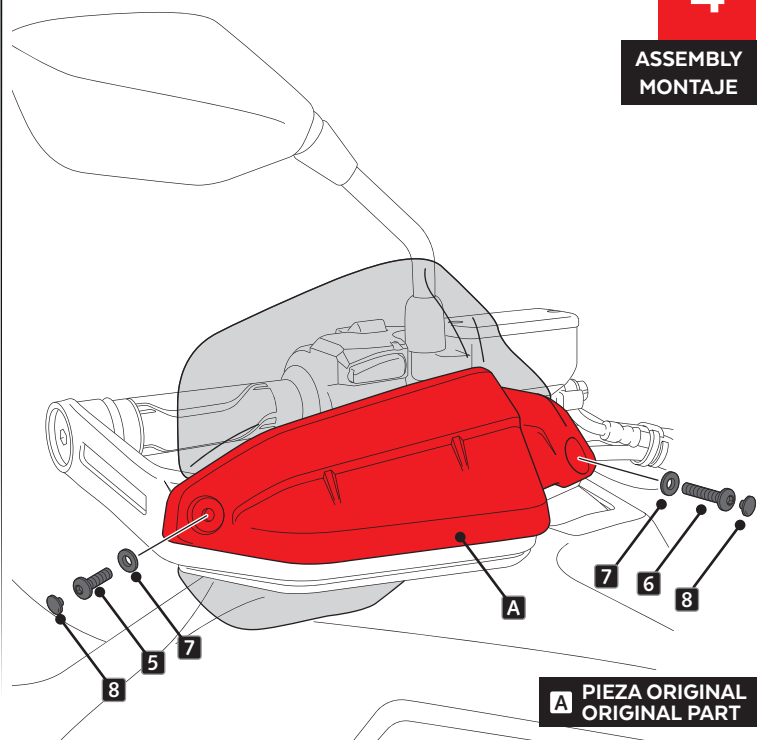

**A** PIEZA ORIGINAL  
ORIGINAL PART