

# SUZUKI GSX-8S '23-

## M O U N T I N G I N S T R U C T I O N S

REF 21698

**ENGINE SPOILER**



1 Person



30 min



EASY



PHILLIPS



FIX



Nº 8

ALLEN



Nº 3

Nº 4

ID.	PIEZA/PART	DESCRIPCIÓN	DESCRIPTION	QTY.	REF.:
1		Quilla	Engine spoiler	1	21698J/CM3
2		Soporte izquierdo delantero	Front left support	1	SOPOR4P6FL21698
3		Soporte izquierdo trasero	Rear left support	1	SOPOR4P6RL21698
4		Soporte derecho delantero	Front right support	1	SOPOR4P6FR21698
5		Soporte derecho trasero	Rear right support	1	SOPOR4P6RR21698
6		Silentblock Ø12xØ6x9	Ø12xØ6x9 Silentblock	4	AROPASACABLES-3
7		Casquillo con valona Ø12xØ6,8x7,3	Ø12xØ6,8x7,3 bush with flange	4	CASQUI-1A---750
8		Tornillo allen M5x16 Ø11 ISO 7380	M5x16 Ø11 ISO 7380 allen screw	4	TORNI-I7380-493
9		Tapón tornillo M5 ISO 7380	M5 ISO 7380 screw cap	4	TAPON-----85
10		Tornillo Ø5x20 DIN7505/B	Ø5x20 DIN7505/B screw	2	TORNI-D7505-932
11		Tornillo M6x20 Ø14 ISO7380	M6x20 Ø14 ISO7380 allen screw	1	TORNI-I7380-404
12		Casquillo Ø6,5 xØ13 x8,5mm	Ø6,5 xØ13 x8,5mm arrowhead	1	CASQUI-----0298
13		Tornillo allen M6x10 Ø14 ISO 7380	M6x10 Ø14 ISO 7380 allen screw	2	TORNI-I7380-402

# SUZUKI GSX-8S '23-

INSTRUCCIONES DE MONTAJE - MOUNTING INSTRUCTIONS - MONTAGEANLEITUNG

**1**

ASSEMBLY  
MONTAJE

RIGHT SIDE

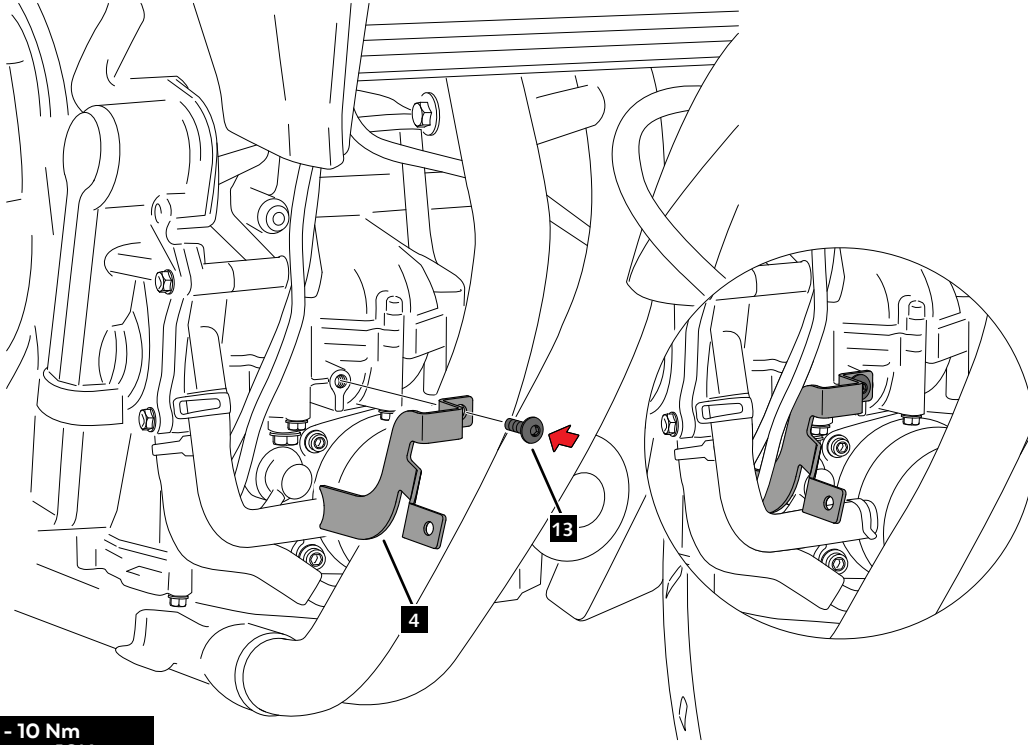

**13**  Par de apriete - 10 Nm  
Tightening torque - 10Nm

**2**

DISASSEMBLY  
DESMONTAJE

RIGHT SIDE

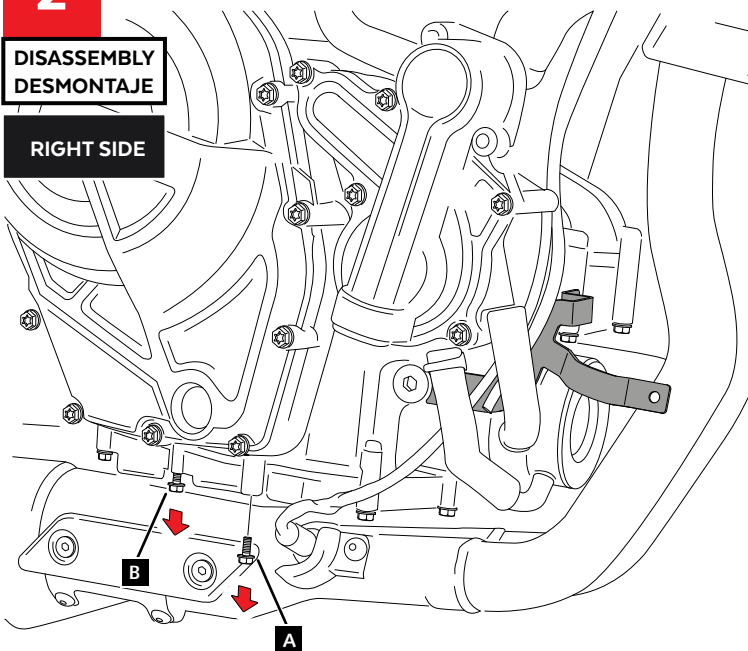

**B** Solo aflojar  
Only loosen

**3**

ASSEMBLY  
MONTAJE

RIGHT SIDE

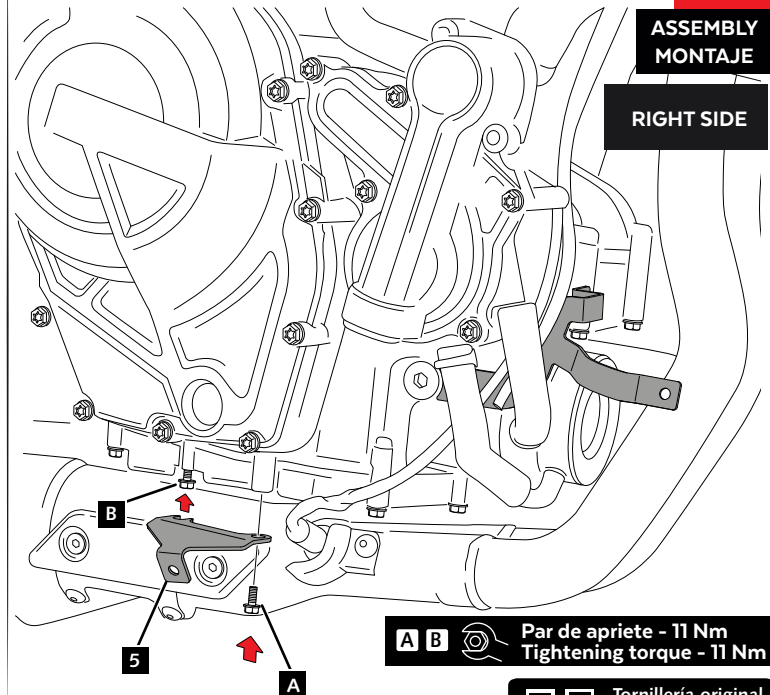

**A B**  Par de apriete - 11 Nm  
Tightening torque - 11 Nm

**A B** Tornillería original  
Original screws

# SUZUKI GSX-8S '23-

INSTRUCCIONES DE MONTAJE - MOUNTING INSTRUCTIONS - MONTAGEANLEITUNG

**4**

**DISASSEMBLY  
DESMONTAJE**

**LEFT SIDE**

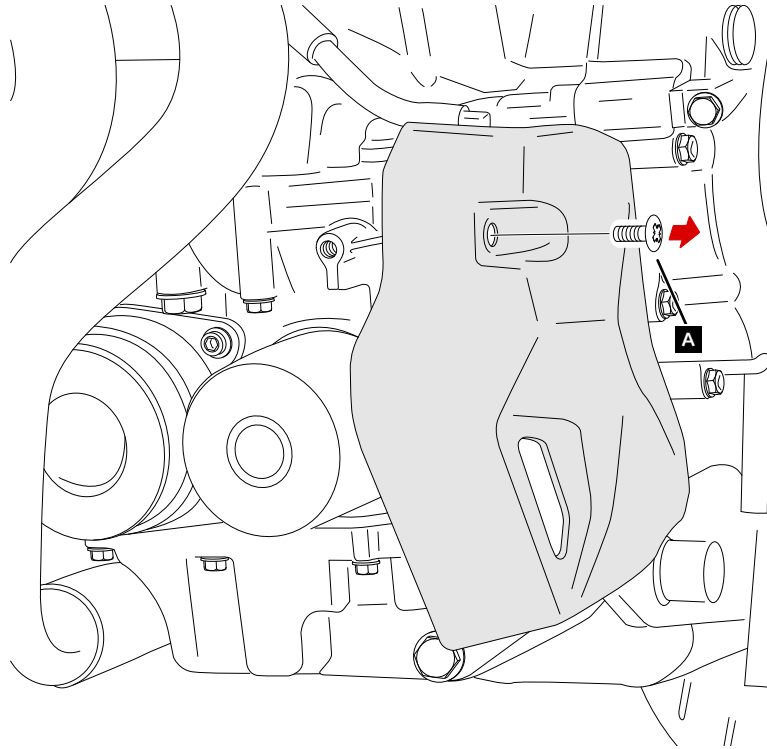

**A** Tornillería original  
Original screws

**5**

**ASSEMBLY  
MONTAJE**

**LEFT SIDE**

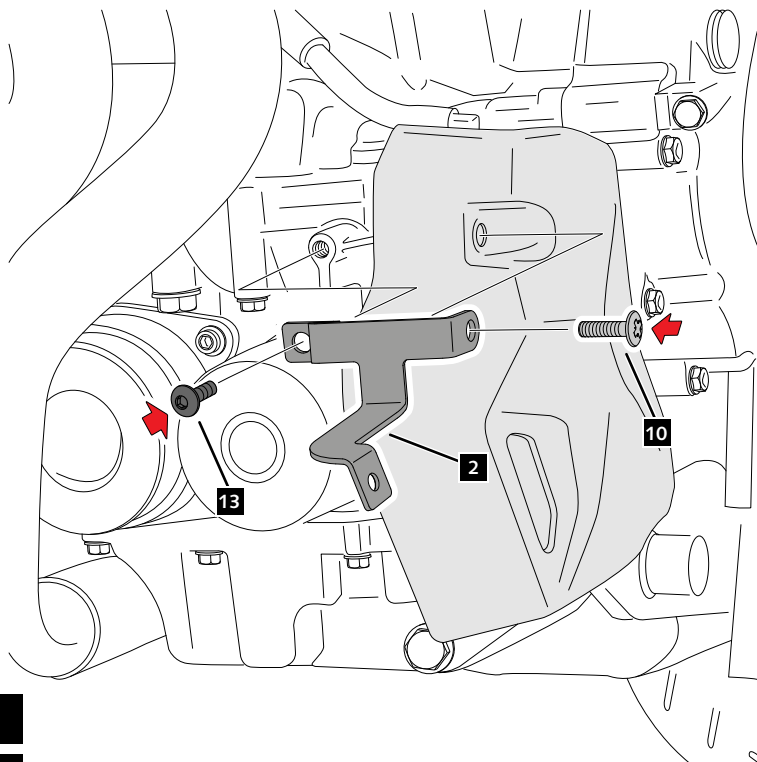

**13**  Par de apriete - 10 Nm  
Tightening torque - 10Nm

**10**  Par de apriete - 2 Nm  
Tightening torque - 2 Nm

# SUZUKI GSX-8S '23-

INSTRUCCIONES DE MONTAJE - MOUNTING INSTRUCTIONS - MONTAGEANLEITUNG

**6**

**DISASSEMBLY  
DESMONTAJE**

**LEFT SIDE**

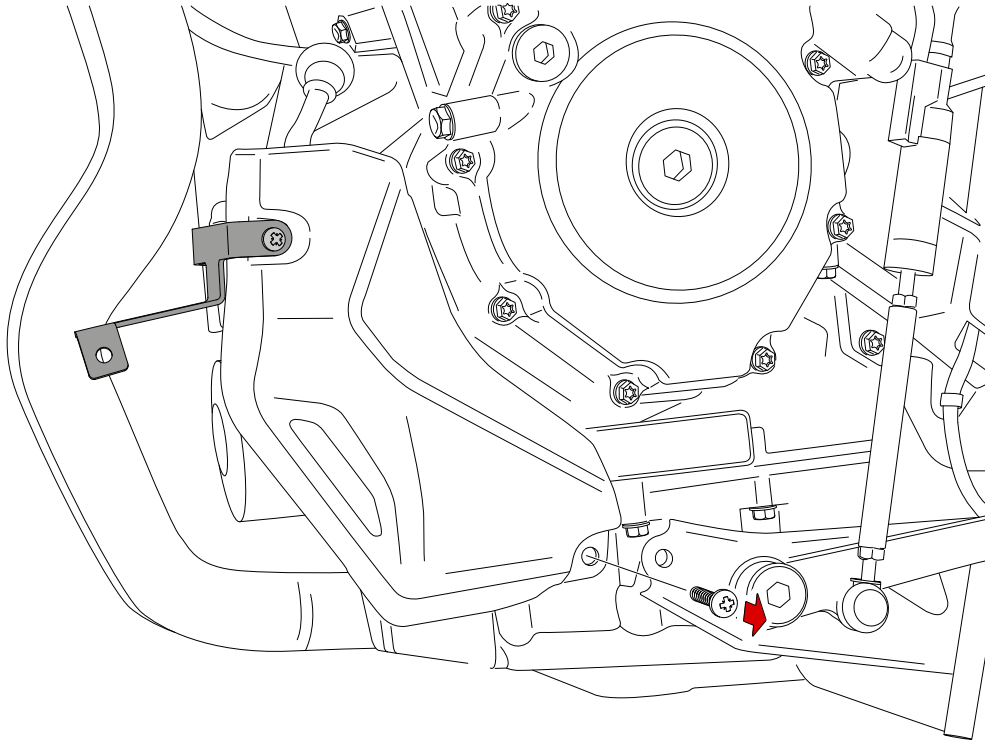



**7**

**ASSEMBLY  
MONTAJE**

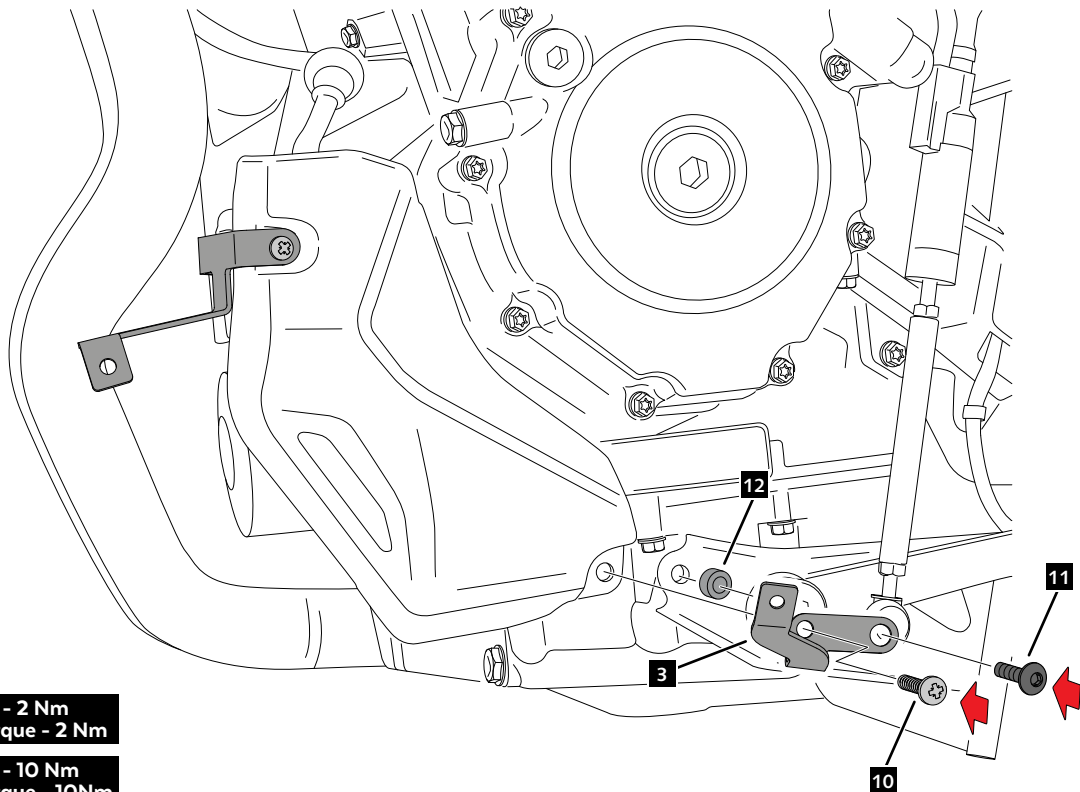
**LEFT SIDE**



**10**  Par de apriete - 2 Nm  
Tightening torque - 2 Nm

**11**  Par de apriete - 10 Nm  
Tightening torque - 10Nm

# SUZUKI GSX-8S '23-

INSTRUCCIONES DE MONTAJE - MOUNTING INSTRUCTIONS - MONTAGEANLEITUNG

**8**

ASSEMBLY  
MONTAJE

LEFT SIDE

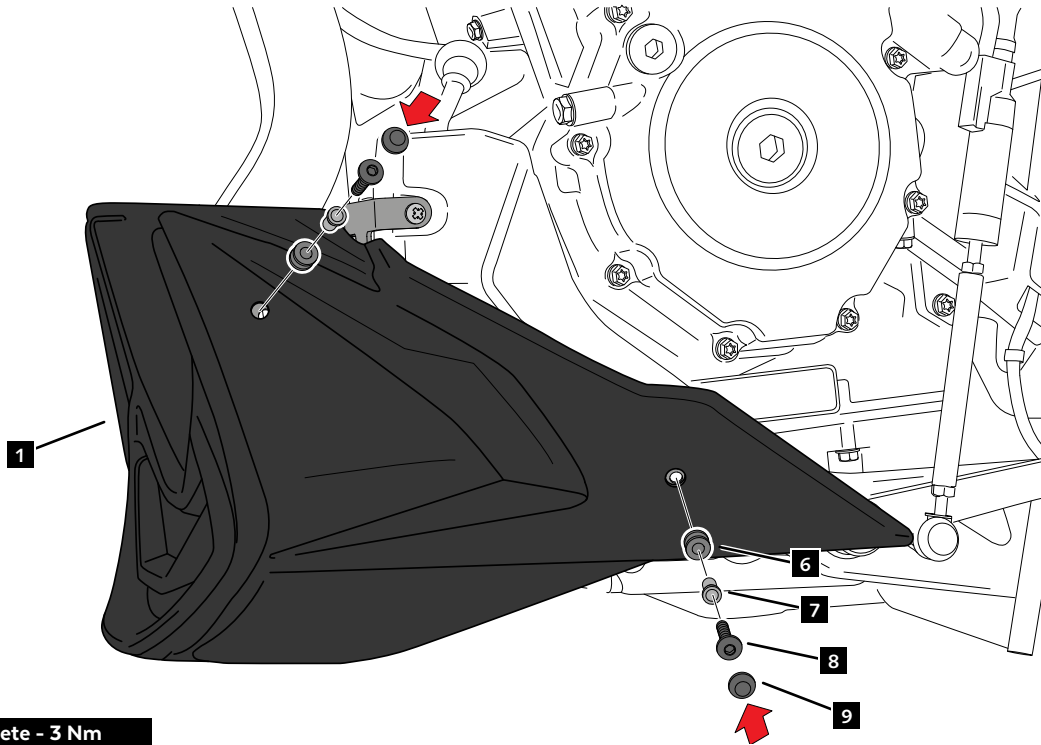



**8**  Par de apriete - 3 Nm  
Tightening torque - 3 Nm

**9**

ASSEMBLY  
MONTAJE

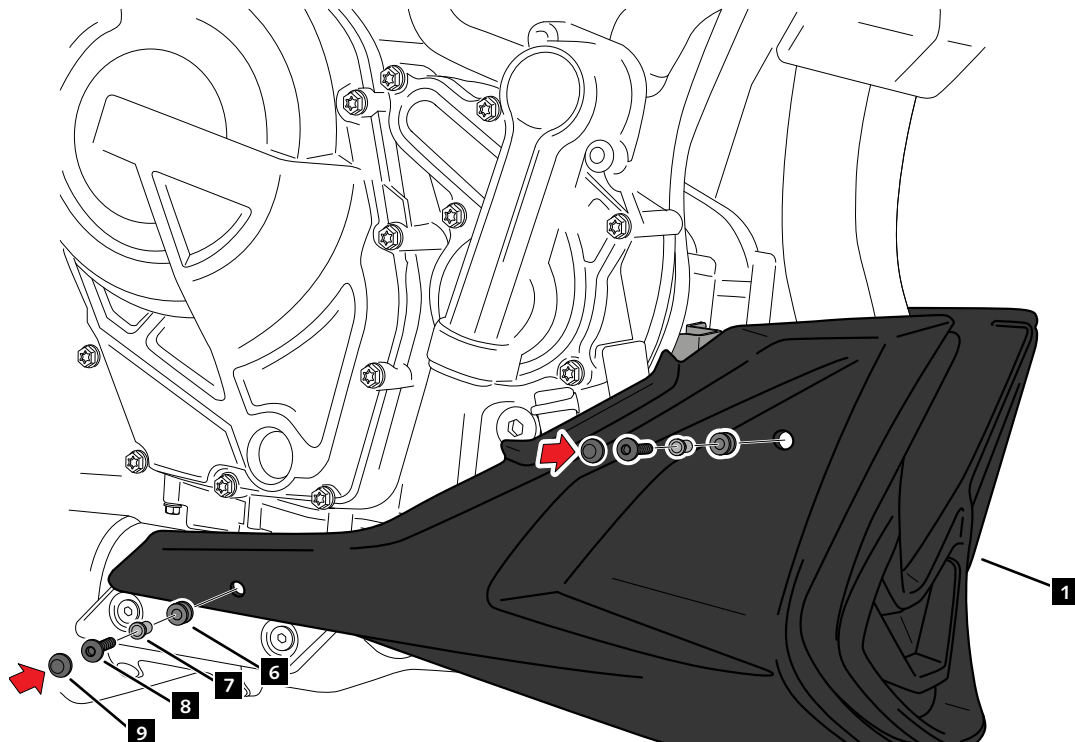
RIGHT SIDE



**8**  Par de apriete - 3 Nm  
Tightening torque - 3 Nm