

# KTM 1290 SUPERDUKE GT '19-

## M O U N T I N G I N S T R U C T I O N S

REF 3564

CÚPULA TOURING / TOURING SCREEN / TOURENCHIEBE



ID.	PIEZA/PART	DESCRIPCIÓN	DESCRIPTION	QTY.	REF.:
1		Cúpula touring	Touring screen	1	3564F/W/H/NM3
2		Tornillo especial M5x9 Long Hexagonal 14	M5x9 special screw Hexagonal Length 14	4	TORNI-EC----597
3		Silentblock Ø9xØ6x8mm	Ø9xØ6x8mm silentblock	4	AROPASACABLES-3
4		Casquillo con valona Ø12xØ6,8x7,3	Ø12xØ6,8x7,3 bush with flange	4	CASQUI-1A---750
5		Tornillo M5x16 Ø11 ISO 7380	M5x16 Ø11 ISO 7380 allen screw	4	TORNI-I7380-493
6		Tapon M5 ISO 7380	M5 ISO 7380 cap	4	TAPON-----85

# KTM 1290 SUPERDUKE GT '19-

INSTRUCCIONES DE MONTAJE - MOUNTING INSTRUCTIONS - MONTAGEANLEITUNG

**1**

**DISASSEMBLY  
DESMONTAJE**

**A** Tornillería original  
Original screw

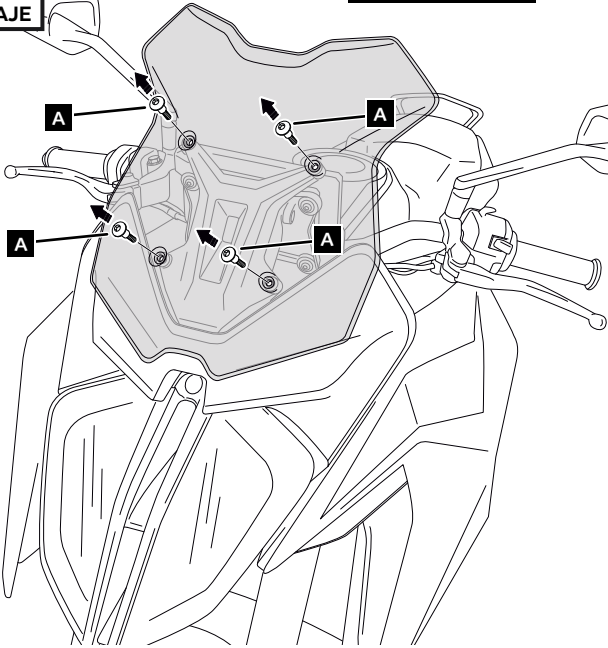

**2**

**ASSEMBLY  
MONTAJE**

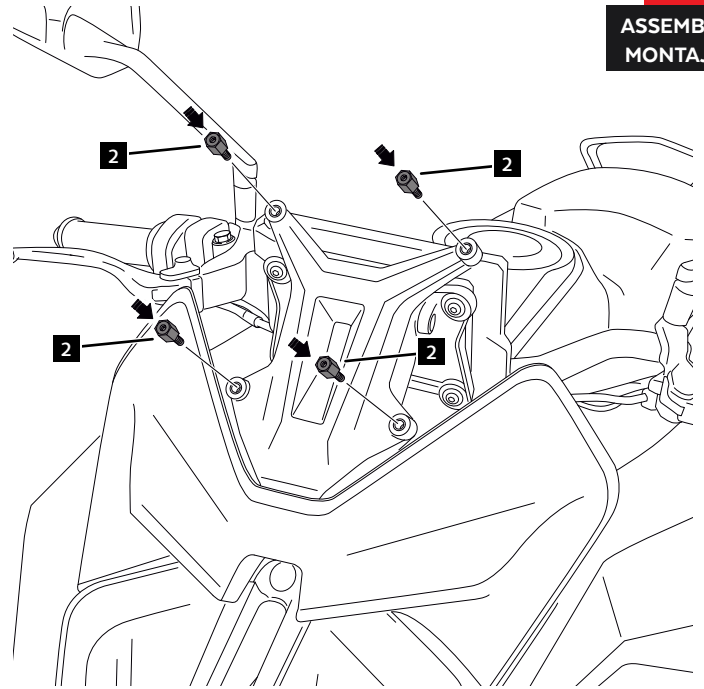

**3**

**ASSEMBLY  
MONTAJE**

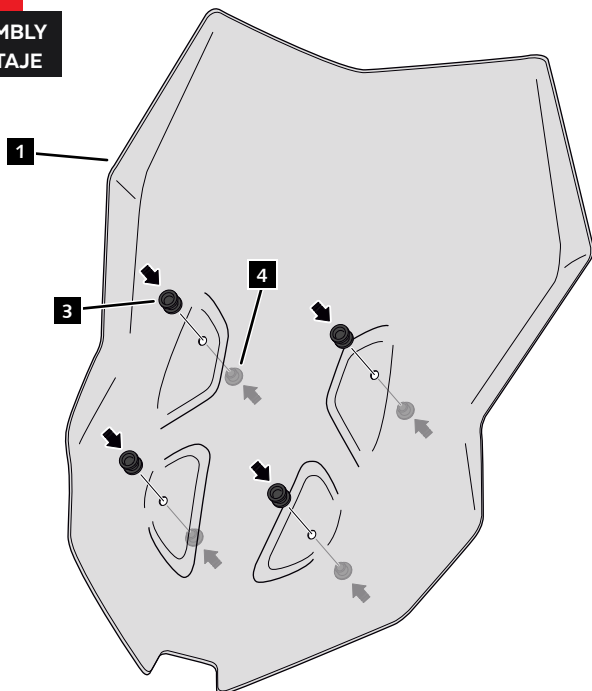

**4**

**ASSEMBLY  
MONTAJE**

